

FLOOR PLAN

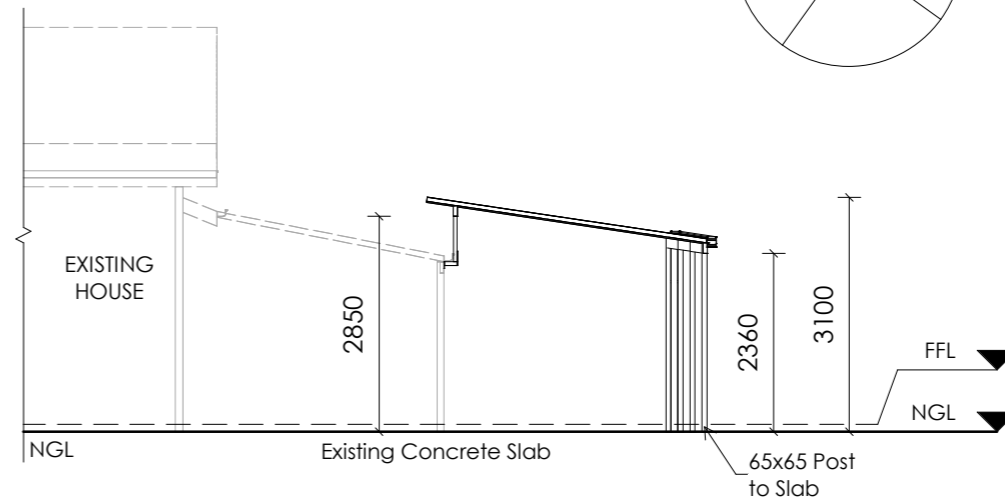

NORTH ELEVATION



WEST ELEVATION

SOUTH ELEVATION

PRODUCT AND MATERIALS

CONTRACT NO. TA6588

- POSTS : WHITE
- BEAMS : WHITE
- ROOFING : WHITE
- DOWNPIPE : WHITE
- GUTTER : BASALT

Notes:

- Panel Lock Roof
- Beams 140x50
- Posts 65x65
- Posts to be bolted to Slab
- To connect to existing grate/pit

STORMWATER DRAINAGE, GUTTERS AND DOWNPIPES TO BE INSTALLED IN ACCORDANCE WITH AS3500.3 OR NCC HOUSING PROVISIONS 2022 PART 3.3.

SHEET ROOF TO COMPLY WITH NCC HOUSING PROVISIONS 7.2 AND NCC VOL2 H1D7

GUTTERING TO COMPLY WITH NCC HOUSING PROVISIONS 7.4

This document and design is confidential and remains the copyright of Spanline Home Additions. Copyright and usage of this document is not transferable without the written consent of Spanline Home Additions. Acting upon, disclosing, copying, or distributing this document or any portion of it is prohibited and may cause those responsible to be liable to prosecution.

REV	DESCRIPTION	BY	DATE

STATUS:
ALL DIMENSIONS TO BE CHECKED ON SITE PRIOR TO CONSTRUCTION
DRAWINGS TO BE READ IN CONJUNCTION WITH RELEVANT ENGINEERING



Picton Bros Improvements Pty Ltd
 p. 02 68840899, Lic #83737C
 a. 183 Talbragar St, Dubbo, NSW 2830
 e. gschnitzer@pictonbros.com.au
 w. www.spanline.com.au

CLIENT:
Les & Kerrie Iles
 54 Queen Street,
 Uralla, NSW 2358.
 Lot: 27, DP604479

BUILDER:
Spanline Tamworth
 183 Talbragar Street, Dubbo
 NSW 2830

SITE:
 54 Queen Street,
 Uralla, NSW 2358.
 Lot: 27, DP604479

TITLE:
Floor Plan & Elevations

SCALE AT A3: 1 : 100	DATE: 11/02/2025	DRAWN: SYN	CHECKED: GCS
PROJECT NO: TA6588	DRAWING NO: TA6588 - 02	REVISION:	A