

Hill Street

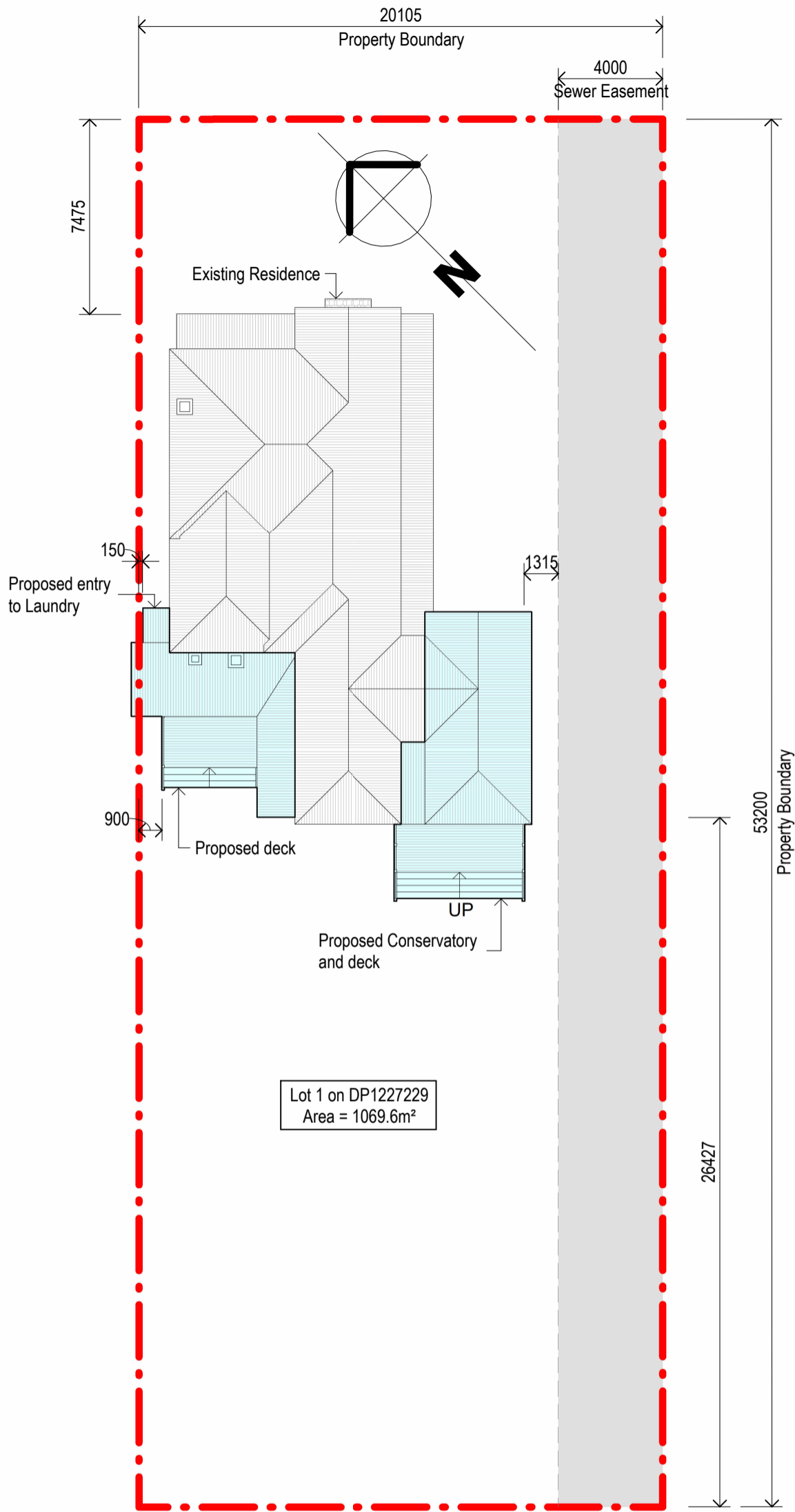

NOTES:

- All dimensions are in millimetres unless noted otherwise.
All levels and site conditions are to be confirmed on site prior to the ordering of materials or commencement of construction.
- All work is to be carried out in accordance with the National Construction Code (NCC), the relevant Australian design standards and **BASIX Certificate No.: A1749656_02**
All timber framework to AS1684.
All concrete slabs and footings to AS2870 and Engineer's specification.
- Exhaust fans will be discharged to the eaves / outside air in accordance with NCC H4D7 Ventilation (or discharged to the roof cavity with evenly distributed openings installed in accordance with NCC H4D9 Condensation Management).
- Vapour permeable (i.e. breathable) wall sarking to be installed in accordance with NCC 2022 Part 10.8 Condensation management.
- Falls in wet area floors are to be in accordance with HP 10.2.12 and NCC H4D2.
All waterproofing works to be in accordance with the NCC 2022 H4D2.
- All downpipes (DP) are shown in nominal locations that should be confirmed on-site by a licensed plumber. All downpipes are to be connected to the water tank with overflow to be overland.

1

Site Plan

1 : 200

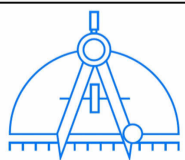

MARSHALL
DRAFTING SERVICES
20 Kuranda Avenue
Armidale NSW 2350
M: 0438 770 279
E: marshalldrafting@gmail.com

| No. | Description | Date |
|-----|--------------|----------|
| A | Client Issue | 09.04.24 |
| B | Client Issue | 30.05.24 |
| C | Client Issue | 28.08.24 |
| D | Client Issue | 30.08.24 |

A & L. Sawtell

Proposed additions & alterations

64 Hill Street
Uralla NSW 2365

Site Plan, Notes & Schedules

| | | | |
|----------------|-------------|-------|---------|
| Project Number | 24027 | WD-01 | D |
| Date | 08/04/2024 | | |
| Drawn by | C. Marshall | Scale | 1 : 200 |
| Checked by | C. Marshall | | |