

LOT 117 DP753840
685ha

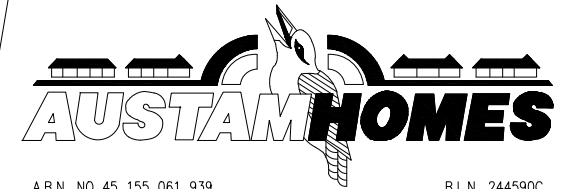

A.B.N. NO 45 155 061 939

B.L.N. 244590C

PPR CONSTRUCTIONS PTY LTD
TAMWORTH N.S.W. 2340

SITE PLAN NOT TO SCALE

NOTE: SEDIMENT & EROSION CONTROL MEASURES ARE NOT REQUIRED AS NO EXCAVATION OR SITE DISTURBANCE WILL OCCUR DUE TO FOOTINGS BEING PIERS ONLY.

ALL ROOF WATER TO TANKS THEN OVERFLOW TO 3 METERS CLEAR OF TANKS, BUILDING AND BOUNDARIES. ONLY APPLICABLE TO RURAL PROPERTIES

JOB No. 9617	PROPOSED LANGLEY ADDITION FOR LINDA HUGHES AT 339 LOOANGA ROAD, BENDEMEER	
15/01/2025	DWG No. 24809	DRAWN SF
A3	1:100	SHEET 4 OF 5
These plans remain the property of AUSTAM HOMES. Any attempt to copy in whole or part, shall be deemed as breach of copyright.		

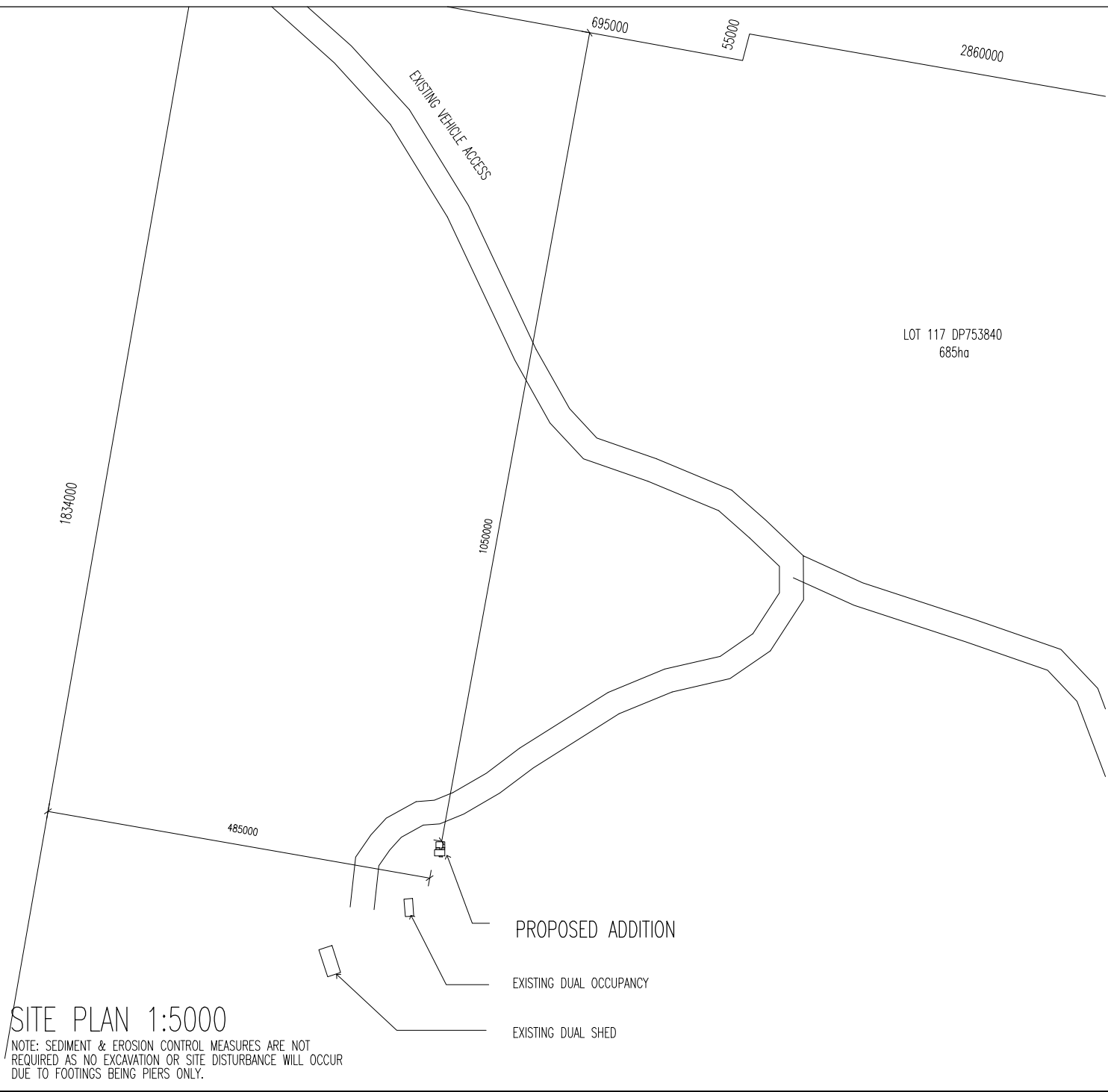

LOT 117 DP753840
685ha

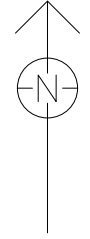

A.B.N. NO 45 155 061 939

B.L.N. 244590C

PPR CONSTRUCTIONS PTY LTD
TAMWORTH N.S.W. 2340

SITE PLAN 1:5000

NOTE: SEDIMENT & EROSION CONTROL MEASURES ARE NOT REQUIRED AS NO EXCAVATION OR SITE DISTURBANCE WILL OCCUR DUE TO FOOTINGS BEING PIERS ONLY.

- PROPOSED ADDITION
- EXISTING DUAL OCCUPANCY
- EXISTING DUAL SHED

JOB No. 9617	PROPOSED LANGLEY ADDITION FOR LINDA HUGHES AT 339 LOOANGA ROAD, BENDEMEER	
15/01/2025	DWG No. 24809	DRAWN SF
A3	1:100	SHEET 5 OF 5

These plans remain the property of AUSTAM HOMES. Any attempt to copy in whole or part, shall be deemed as breach of copyright.