

LEGEND

T	TELSTRA PIT
E	ELECTRICAL PIT
WM	WATER METER
PP	POWER POLE
DP	DOWNPIPE
SWP	STORMWATER PIT
SMH	SEWER ACCESS CHAMBER
KIP	KERB INLET PIT
H	HYDRANT
LB	LETTER BOX
LP	LIGHT POLE
GAS	GAS PIT
-10000	APPROX. SURFACE CONTOUR
⊙	DESIGN SURFACE LEVEL
AHD 400	AUST HEIGHT DATUM LEVEL
-SW -SW-	STORMWATER DRAINAGE
-S -S-	SEWER
-W -W-	WATER
-T -T-	TELSTRA
-OPT -OPT-	OPTIC FIBRE
-E -E-	ELECTRICAL
-OHP -OHP-	OVERHEAD POWER
-GS -GS-	GAS LINE
-EXSW -EXSW-	EXISTING STORMWATER
-EXS -EXS-	EXISTING SEWER

SITE DETAILS

SITE AREA:	345 sqm
LEP-ZONING:	RU1 PRIMARY PRODUCTION
LOCAL GOVERNMENT AREA:	URALLA SHIRE COUNCIL
DEVELOPMENT TYPE:	PROPOSED NEW SHED
BUILDING CLASSIFICATION:	CLASS 10A
WIND CLASSIFICATION:	N3 SITE CLASSIFICATION TO AS 4055-2021
SOIL CLASSIFICATION:	REFER TO ENG. DETAILS
CLIMATE ZONE:	6 (WWW.ABCB.GOV.AU MAP)
BUSHFIRE PRONE LAND:	AREAS OF BUSHFIRE PRONE VEGETATION
OTHER CONTROLS:	BIO DIVERSITY MAP

SITE LOCATION PLAN

1 : 10000

SAE DESIGN
RESIDENTIAL • COMMERCIAL

A | P.O. Box 470 Tamworth NSW 2340 M | 0411285823 E | mail@saedesign.com.au

PROPOSED NEW SHED
313 GOSTWYCK ROAD, URALLA
ADAMS

COPYRIGHT No part of this drawing, information or data documented maybe copied or reproduced without prior permission from SAE Design.

SCALE	As indicated	REVISION	DESCRIPTION	DATE	PROJECT No.
DATE	25/10/2024	1	PRELIMINARY ISSUE	14/10/2024	1207-24
DRAWN	SAE	2	FOR APPROVAL	25/10/2024	SHEET
DESIGNED	SAE				A001

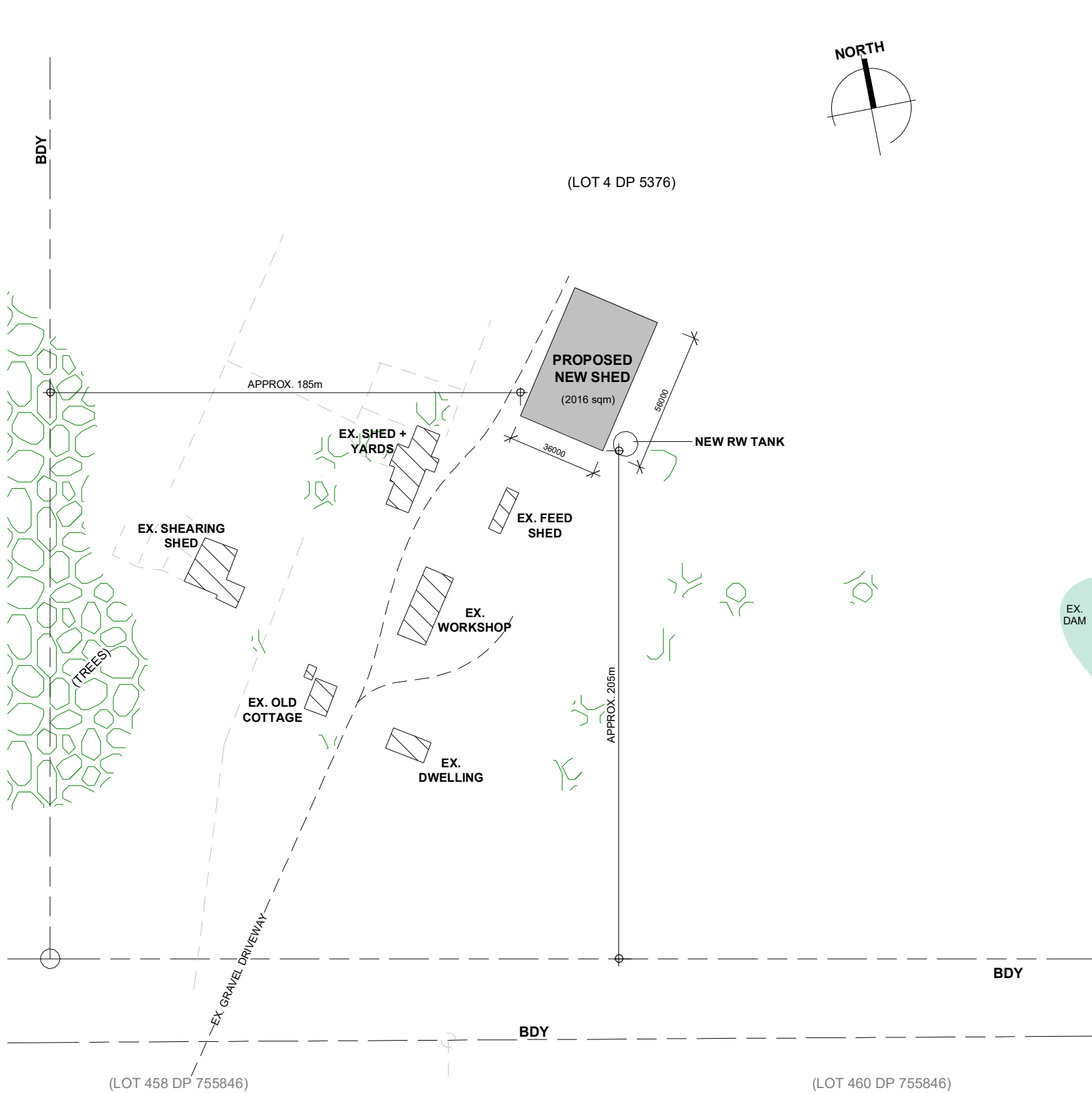

SITE PLAN - Callout 1

1 : 2000

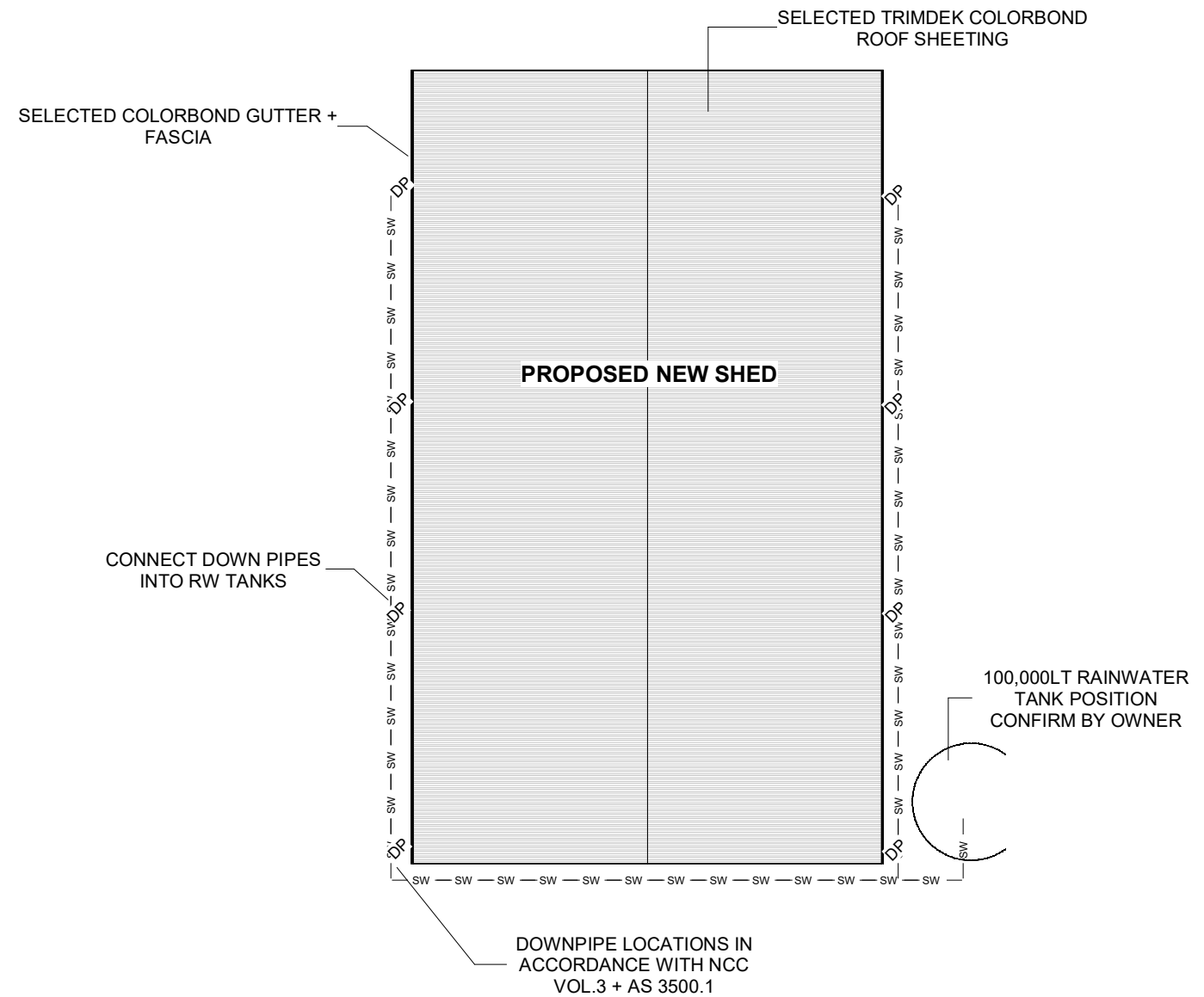

ROOF PLAN

1 : 500

SITE NOTES

ALL SURFACE WATER TO FALL AWAY FROM BUILDING IN ALL DIRECTIONS IN ACCORDANCE WITH REQUIREMENTS OF AS2870 + NCC HP PART 3.3.3

DOWNPIPES TO BE CONNECTED INTO STORMWATER AS SOON AS THE ROOF IS INSTALLED.

DOWNPIPES SHOULD BE AT A MAXIMUM OF 12 METER CENTRES + AS CLOSE TO VALLEYS AS POSSIBLE AND IN ACCORDANCE WITH NCC HP PART 7.4 + NCC VOL. 3

EXCAVATED MATERIAL STORED ON SITE SHALL BE PLACED UP-SLOPE OF SEDIMENT FENCE. INSTALL A SEDIMENT FENCE ON THE DOWNSLOPE SIDE OF MATERIAL.

CONSTRUCTION VEHICLES TO BE PARKED ON THE STREET, TO PREVENT TRANSFERRING DEBRIS ONTO STREET. UNLESS ALTERNATIVE SEDIMENT TRANSFER REDUCTION METHODS ARE IN PLACE

ALL EXISTING UNDERGROUND SERVICES MUST BE LOCATED AND EXPOSED PRIOR TO EARTHWORKS COMMENCING & IT IS THE RESPONSIBILITY OF THOSE PERSONS USING THIS PLAN TO CONFIRM BOTH POSITION & LEVEL OF THESE UTILITIES IN CONJUNCTION WITH THE APPROPRIATE AUTHORITY.